

C E S A R

INTARSIO

Design by García Cumini

The Intarsio system is inspired by the idea of taking apart the two-dimensional surface of traditional doors to break away from their customary geometry. Rearranging the door contours and the wood grain creates a very vivid optical illusion on a noble, traditional material such as wood, generating a creative rhythm with a strong personality.



90° DOOR

2.2 cm thick door suitable for all the opening systems in the Cesar collection (handles, grip recesses, push-to-open, shaped grip edgings). Compatible with Cesar's wide range of finishes and modules.

DOOR STRUCTURE



Fibreboard panel

- 1) Door front finished with 0.6 mm thick veneer
- 2) 10 x 8 mm solid wood "embedded" in the panel's surface



INTARSIO

Design by García Cumini



GENERAL INFORMATION INTARSIO DOOR

- Veneered door with two grain directions (horizontal and vertical).
- Matching vertical grain.
- The vertical panel will always be 30-cm wide regardless of the overall size of the door. 30 and 15-cm wide doors will always be finished with a vertical grain.

WOOD GRAIN PAIRINGS

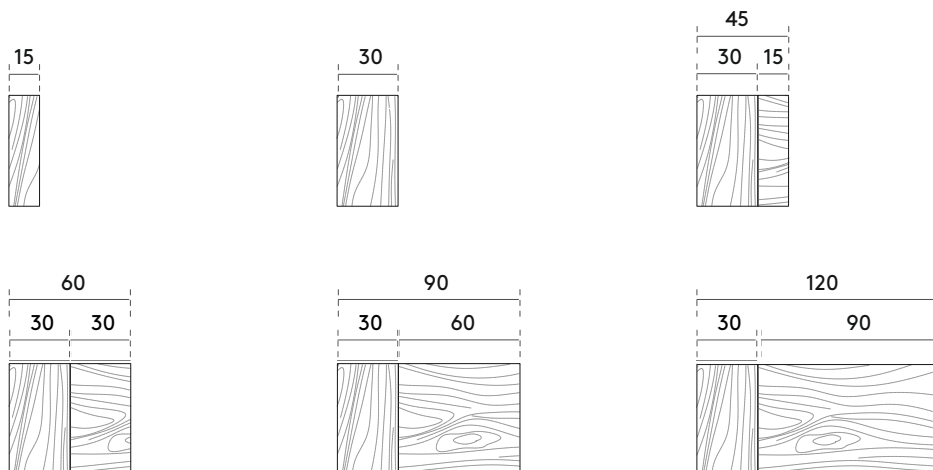

INTARSIO

Design by García Cumini

GENERAL INFORMATIONS

Door thickness 22 mm

Door edge

90° door



Opening methods

grip recess

The grip recess opening system has been designed so that our kitchen modules can be opened by grasping the panel from a gap at the top or the side of the door. It creates a straight empty space between the door and the worktop or between the door and the edge of the carcass. The grip recess is a door opening system that doesn't require a handle.



push pull



door with handle



grip edgings



C E S A R

INTARSIO

Design by García Cumini

MODULARITY

BASE UNITS

Depth	35/47/62/67 cm
Width	15/30/45/60/75/90/105/120/180*/240* cm
Height	39/48/58.5/60/78/84 cm

TALL UNITS

Depth	35/62 cm
Width	30/45/60/69*/90/120/138*/276* cm
Height	138/198/210/222 cm

WALL UNITS

Depth	35 cm
Width	15/30/45/60/75/90/105/120/150/180/240 cm
Height	36/48/60/72/84/96/120 cm

* Please check the dimensions in the price list

INTARSIO

Design by García Cumini

FINISHES

WOOD VENEERS

A sheet of precious wood veneer is applied to a wood particleboard panel to give the finish a natural look and feel. This type of finish reduces the environmental impact created by felling trees because it replaces solid wood while preserving the same aesthetics. Moreover, it produces a lighter and more stable product. A finishing cycle of acrylic varnish preserves its features during day-to-day use.

90° door	Frame Grip edging
✓	✓

OAK (ROVERE)

is derived from trees belonging to the fagaceae family and is available in a palette of light, medium and dark colours to create timeless settings. First finishes are not available with a continuous grain match.

(vertical grain)



R110

Rovere Nordico Intarsio



R110

Rovere Mediterraneo Intarsio



R103

Rovere Argilla Intarsio

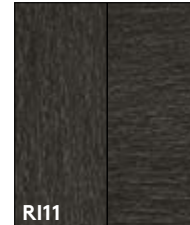

R111

Rovere Fossile Intarsio



R112

Rovere Dark Intarsio

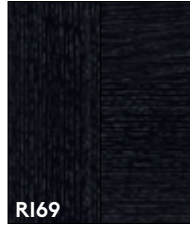

R169

Rovere Corvino Intarsio

ELM (OLMO)

has been appreciated since ancient times for its elegance and the stateliness of its appearance. It boasts timeless beauty, also courtesy of a natural, flamed grain that further enhances its aesthetic harmony. It's available in three versions in the Cesar palette: Sbiancato, Toscano and Grigio. Olmo finishes are supplied with a continuous vertical grain match.

(vertical grain)



R198

Olmo Toscano Intarsio



R197

Olmo Sbiancato Intarsio



R199

Olmo Grigio Intarsio

INTARSIO

Design by García Cumini

FINISHES

90° door	Frame Grip edging
✓	✓

HEAT-TREATED OAK (ROVERE TERMOCOTTO)

an elegant finish achieved by means of an accurate treatment called fuming which can only be performed in hi-tech chambers. It gives the wood even tones and a darker colour while preserving the compactness of the fibres and grain as well as the wood's resistance. The Rovere termocotto finish is produced with a continuous vertical grain match.

(vertical grain)



R186

Rovere Termocotto Intarsio

WALNUT (NOCE)

is a very precious wood species, one of the best in terms of quality, workability and strength. It is available in the "Desaturato" version – a process that brings the original wood grain to the surface, enhancing its beauty – and in the "Sgubbiata" version that "scratches" the surface of thicker-than-standard veneer to bring out its natural appearance. The Noce finishes have a continuous vertical grain match.

(vertical grain)



R190

Noce Desaturato Intarsio

C E S A R

INTARSIO

Design by García Cumini

HANDLES RECOMMENDED BY CESAR

EERO



Champagne



Black nickel



Black



Titanium

SHELL



Champagne



Black nickel



Titanium

OUVERTURE



Brushed Champagne



Brushed Black



Brushed Matt Aluminium



Brushed Bronze

TRATTO



Brushed Champagne



Brushed Black



Brushed Matt Aluminium

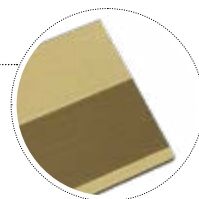

PIPE GODRONATO



Black



Inox

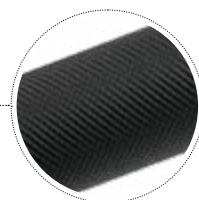

C E S A R

GENERAL FEATURES OF CESAR SYSTEMS

Carcasses: The materials used are FSC / Carb Phase II / TSCA Title VI compliant / F**** and V100 certified and ensure very low formaldehyde emissions and maximum resistance to humidity. They are 18 mm thick to ensure the perfect stability and durability of the hardware used.

Concealed fixings for streamlined carcass interiors. Made of rustproof galvanised metal. Capacity: from 50 kg for wall units to 240 kg for wallhung tall units.

The back panels are in 6-mm thick MDF resistant to smashing and featuring good bending strength. They are coated with water-repellent PPL (polypropylene) matching the colour of the carcass. Certified FSC / Carb Phase II / TSCA Title VI compliant / F****.

The front and rear strengthening bars are in aluminium. These bars are anodised to prevent oxidation. The front bar is finished to match the colour of the carcass.

Shelves can have a matt aluminium or satin black aluminium front edge that increases their beauty and resistance.

Plinths are in aluminium for maximum durability over time and minimum maintenance. They are supplied with a magnetic fastener.

The adjustable feet are in thermoplastic material with a high resistance to impact and feature dimensional stability and durability. Average resistance to compression: 400 kg/each.

Onyx Black Clip Top Blumotion hinges tested for 200,000 opening/closing cycles with integrated dampening system which can be disenabled at will. Can be easily adjusted sideways, vertically and in depth. Most Cesar carcasses mount 3 hinges.

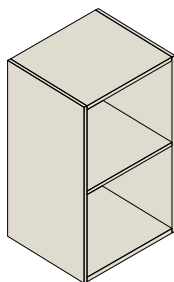

Cenere

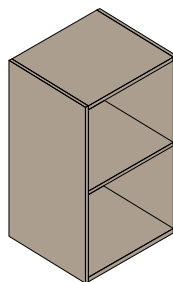

Grigio Fumo

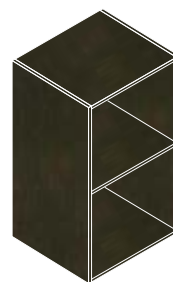

Rovere Bruno

INTARSIO

Design by García Cumini

FINISHES

DRAWER BOX SIDES

Featuring a parallel opening mechanism and a silent, soft-close system. The higher-than-normal drawer box sides ensure 55% more storage capacity than a standard drawer. Capacity: deep drawers 70 kg, drawers 40 kg. The bottom of the drawer can be fitted with elegant, removable mats that simplify cleaning and protect the base while accessories and organisers keep the contents tidy and in place.

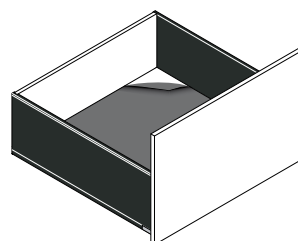
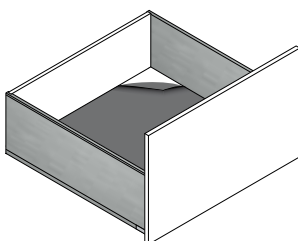
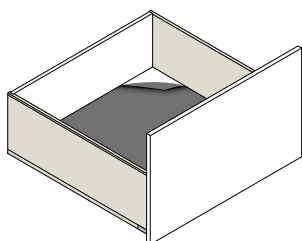
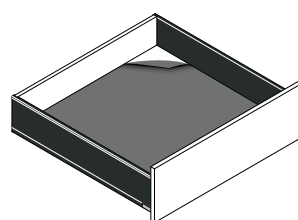
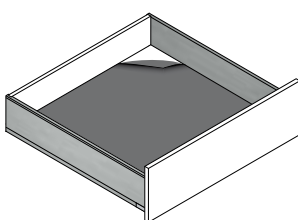
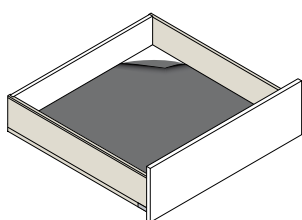

Cenere

Inox

Bruno